

SINCLAIR INLET

GOVERNMENT LOT 3
PATENTED 10/15/1875
VOLUME 1, PAGE 243

GOVERNMENT LOT 2
PATENTED 5/15/1869
VOLUME 1, PAGE 180

GOVERNMENT LOT
PATENTED 5/1/1872
VOLUME 1, PAGE 55

SIDNEY TIDELANDS

FOWLER'S REPLAT

HIGH SCHOOL

LEGEND

UNPLATTED TAX LOT BOUNDARY	006	UNPLATTED TAX LOT NUMBER
PLATTED TAX LOT BOUNDARY	006-21	AUXILIARY UNPLATTED LOT NUMBER
SUPERSEDED TAX LOT BOUNDARY	012-00	PLATTED TAX LOT NUMBER
PLAT LOT BOUNDARY	012-01	AUXILIARY PLATTED TAX LOT NUMBER
EASEMENT BOUNDARY	012-02	SHORT PLAT LOT IDENTIFIATOR
LIFT/ON LOT BOUNDARIES	012-03	SUPERSEDED
PLAT BOUNDARY	4042-001	PLAT BLOCK NUMBER
ENCLOSURE		PLAT LOT NUMBER
CREEK		
NET AREA		

This map was compiled for the Kitsap County Assessor as a record of existing tax lots, for tax assessment purposes only. It is not a survey map.

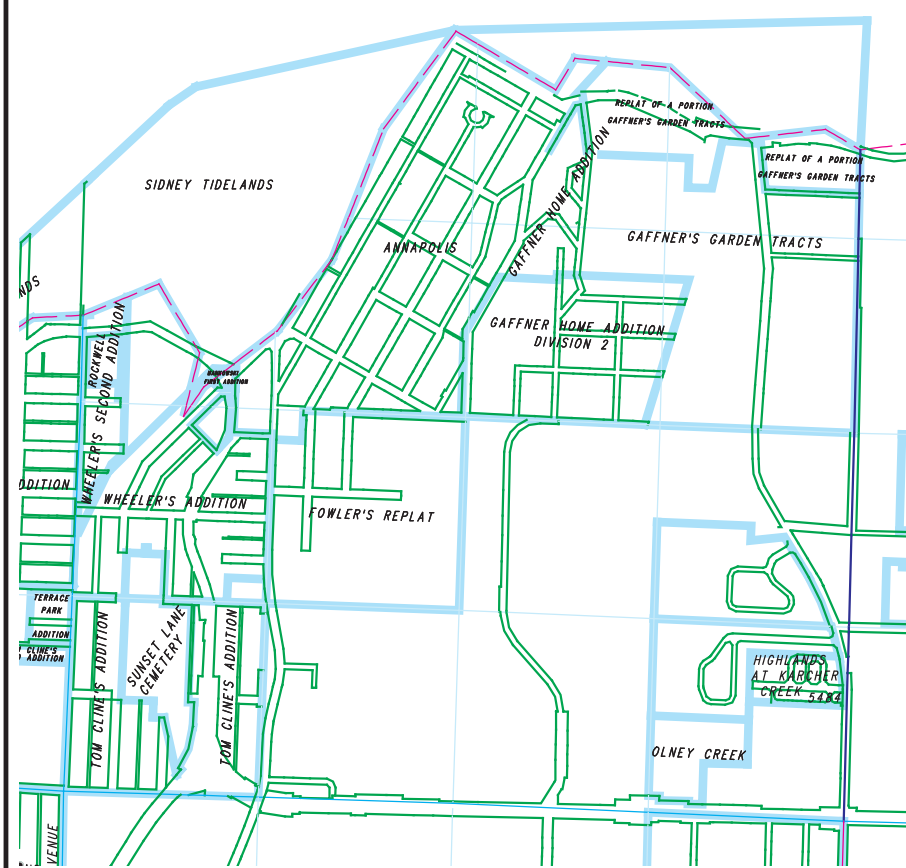

West 1/2 Section 25-24-1E

Scale: 1 = 200'
January 15, 2025

Map Number R25W

