

SINCLAIR INLET

SINCLAIR

GOVERNMENT LOT 4
PATENTED 10/15/1875
VOLUME 1, PAGE 243

GOVERNMENT LOT 5
PATENTED 10/15/1875
VOLUME 1, PAGE 243

GOVT LOT 1
C/S 11/29/81 PAT V6

LEGEND

UNPLATTED TAX LOT BOUNDARY	006	UNPLATTED TAX LOT NUMBER
PLATTED TAX LOT BOUNDARY	006-21	AUXILIARY UNPLATTED LOT NUMBER
SUPERSEDED TAX LOT BOUNDARY	012-00	PLATTED TAX LOT NUMBER
PLAT LOT BOUNDARY	012-00	AUXILIARY PLATTED TAX LOT NUMBER
SUPERSEDED PLAT LOT BOUNDARY	012-00	SHORT PLAT LOT IDENTIFIATOR
EASEMENT BOUNDARY	012-00	SUPERSEDED
LIFT/STAIR LOT BOUNDARIES	4042-001	PLAT BLOCK NUMBER
PLAT BOUNDARY	012-00	PLAT LOT NUMBER
ENCLOSURE		
CREEK		
NET AREA		

This map was compiled for the Kitsap County Assessor as a record of existing tax lots, for tax assessment purposes only. It is not a survey map.

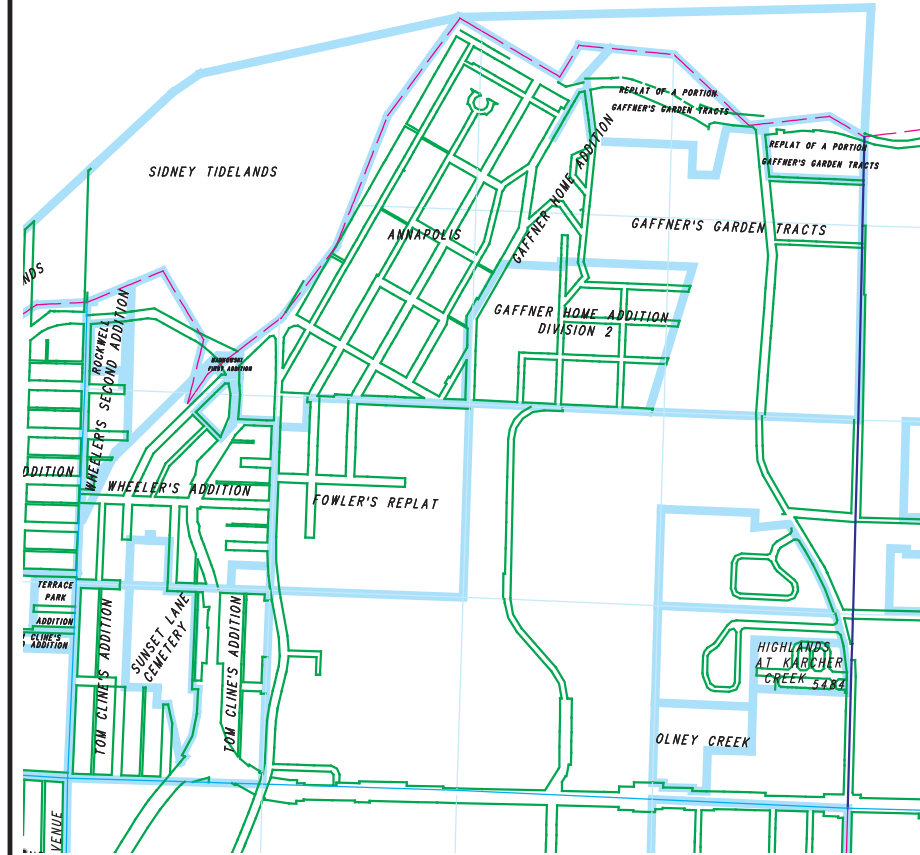

**East 1/2
Section 25-24-1E**

Scale: 1 = 200'
January 15, 2025

Map Number **R25E**

