

LEGEND

	UNPLATTED TAX LOT BOUNDARY	006	UNPLATTED TAX LOT NUMBER
	PLATTED TAX LOT BOUNDARY	(006-21)	AUXILIARY UNPLATTED LOT NUMBER
	SURVEYED TAX LOT BOUNDARY	012-00	PLATTED TAX LOT NUMBER
	PLAT LOT BOUNDARY	(012-01)	AUXILIARY PLATTED TAX LOT NUMBER
	SUPERSUED PLAT LOT BOUNDARY	418-A	SHORT PLAT & LOT DESIGNATOR (SUPERSUED)
	LITTORAL LOT BOUNDARIES	4042-001	PLAT & BLOCK NUMBER
	FLAT BOUNDARY		PLAT LOT NUMBER
	SHORELINE		
	WETAREA		

This map was compiled for the Kitsap County Assessor as a record of existing tax lots, for tax assessment purposes only. It is not a survey map.

South 1/2 Section 14-24-1E

Scale: 1 = 200'
February 10, 2025

Map Number **R14S**

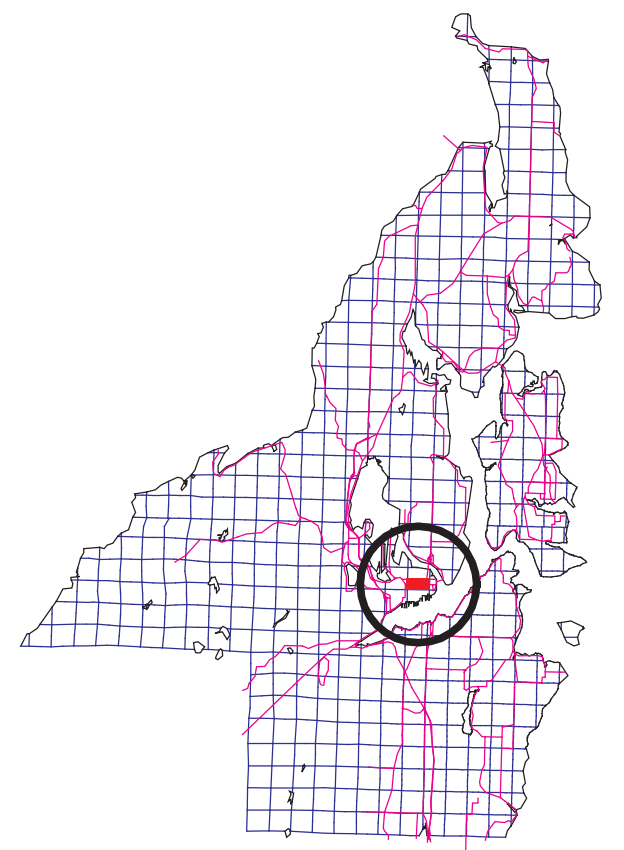
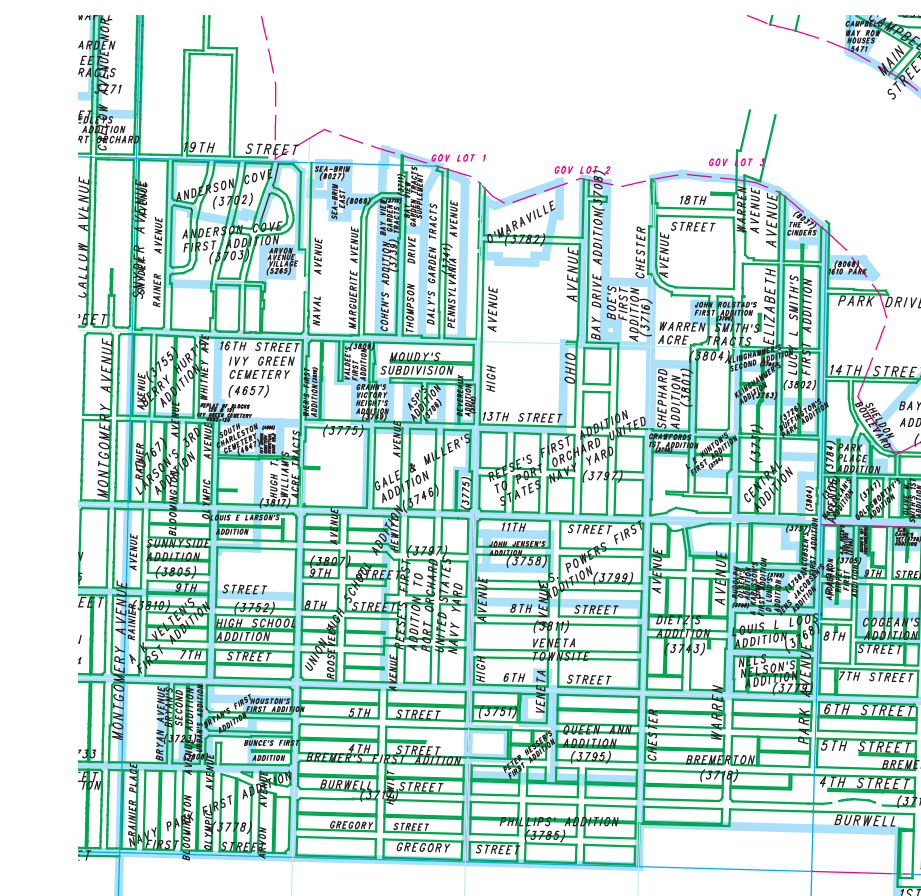

232401-1-001-2007
14 13
23 24