

LEGEND

| | | |
|------------------------------|----------|----------------------------------|
| UNPLATTED TAX LOT BOUNDARY | 006 | UNPLATTED TAX LOT NUMBER |
| PLATTED TAX LOT BOUNDARY | (006-21) | AUXILIARY UNPLATTED LOT NUMBER |
| SUPERSEDED TAX LOT BOUNDARY | 012-00 | PLATTED TAX LOT NUMBER |
| PLAT LOT BOUNDARY | (012-00) | AUXILIARY PLATTED TAX LOT NUMBER |
| SUPERSEDED PLAT LOT BOUNDARY | 4042-001 | SHORT PLAT & LOT IDENTIFIATOR |
| EASEMENT BOUNDARY | 4 | SUPERSEDED |
| LIFTALLOT BOUNDARIES | 4 | PLAT BLOCK NUMBER |
| PLAT BOUNDARY | 4 | PLAT LOT NUMBER |
| ENCLOSURE | | |
| CRACK | | |
| MET AREA | | |

This map was compiled for the Kitsap County Assessor as a record of existing tax lots, for tax assessment purposes only. It is not a survey map.

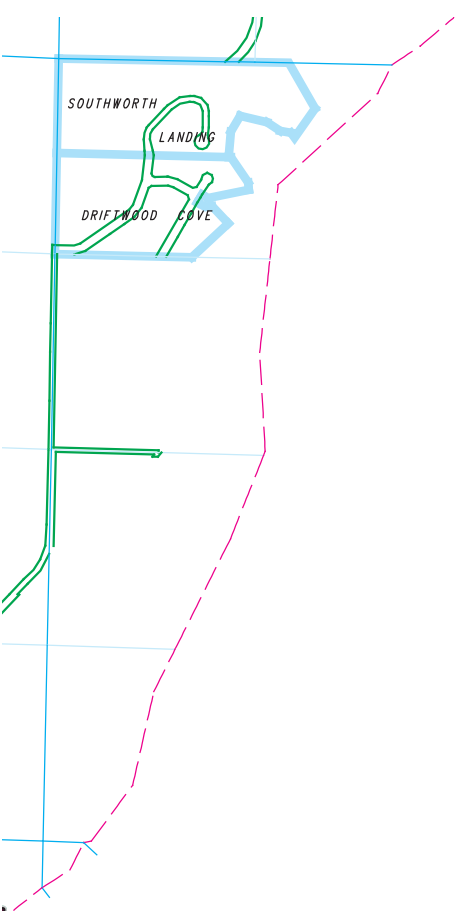

**West 1/2
Section 14-23-2E**

Scale: 1 = 200'
January 13, 2025

Map Number V14W

