

LEGEND	
	UNPLATTED TAX LOT BOUNDARY
	PLATTED TAX LOT BOUNDARY
	SURVEYED TAX LOT BOUNDARY
	PLAT LOT BOUNDARY
	SUPERSEDED PLAT LOT BOUNDARY
	EASEMENT BOUNDARY
	LITTORAL LOT BOUNDARIES
	PLAT BOUNDARY SHORELINE
	CREEK
	WET AREA
	UNPLATTED TAX LOT NUMBER
	AUXILIARY UNPLATTED LOT NUMBER
	PLATTED TAX LOT NUMBER
	AUXILIARY PLATTED TAX LOT NUMBER
	SHORT PLAT & LOT DESIGNATOR SUPERSEDED
	PLAT & BLOCK NUMBER
	PLAT LOT NUMBER

This map was compiled for the Kitsap County Assessor as a record of existing tax lots, for tax assessment purposes only. It is not a survey map.

# North 1/2 Section 09-22-2E

Scale: 1 = 200'  
January 15, 2025

Map Number **Y09N**

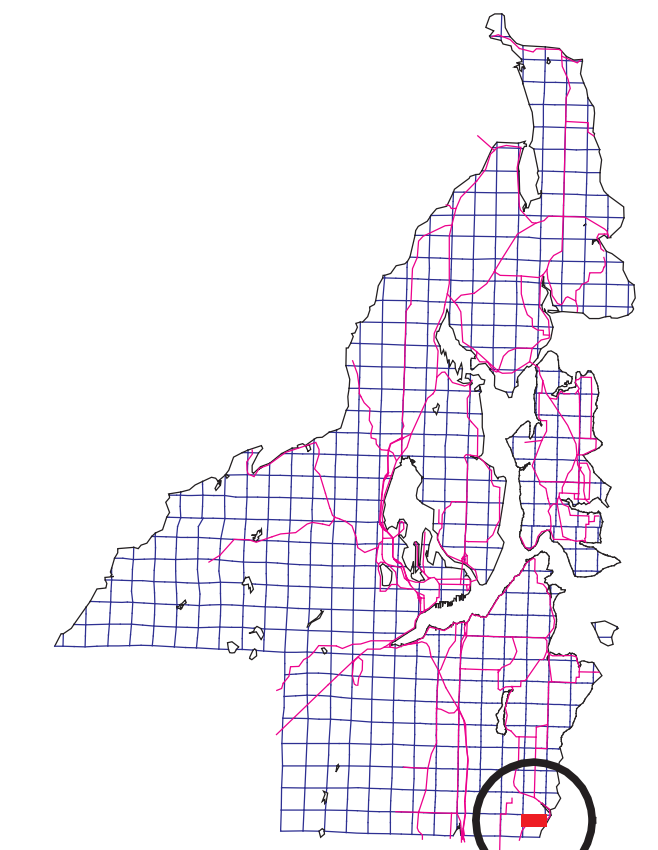
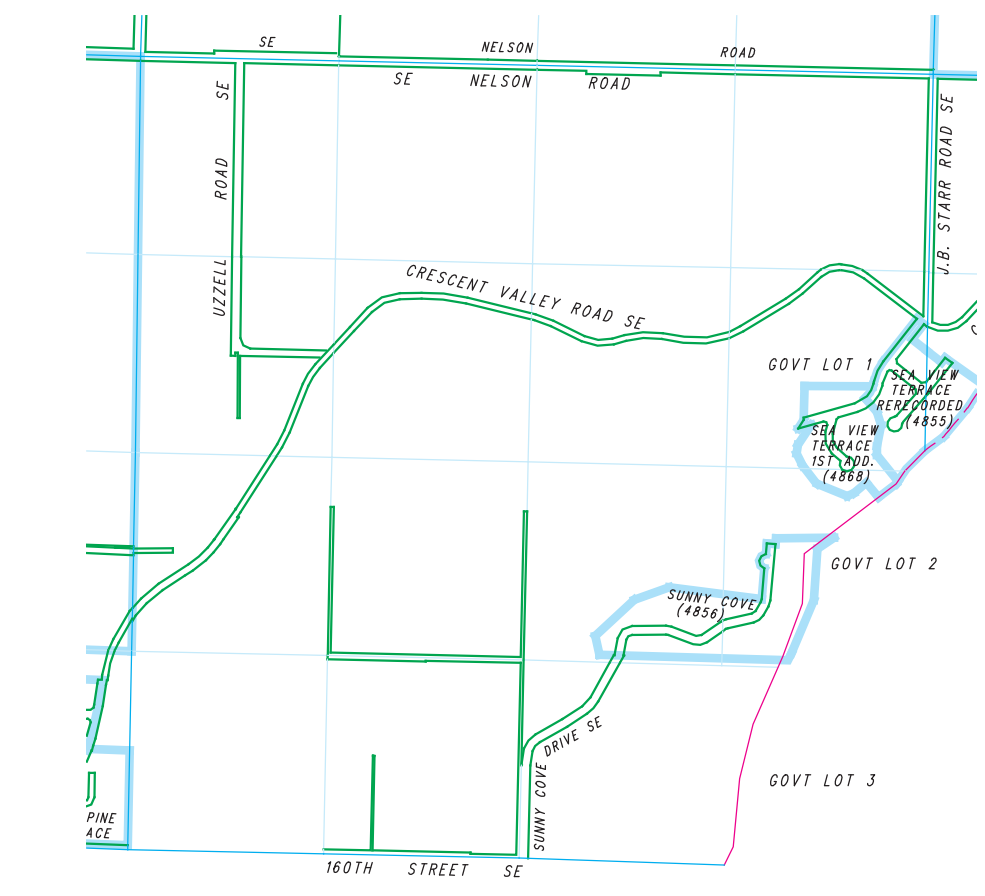

GOVERNMENT LOT 1  
PATENTED 11/23/91  
(C.O.S. 04/23/90)  
VOLUME 4 PAGE 385

• INDICATES 1/8S  
▲ INDICATES 5/8S  
▲ INDICATES 1/400